



**REM PROVIDER** UT 755 LC PLATFORM SUPPORT VESSEL



*The REM fleet is designed by experienced and recognized Norwegian naval architects and built by yards in Norway. The fleet consists of PSV, AHTS, MPSV and OCV. The advanced fleet operates on a world wide basis and is operated by experienced crew, both on board and on shore. This makes REM a highly respected and preferred player in the Offshore Industry.*

## REM PROVIDER UT 755 LC PLATFORM SUPPORT VESSEL

### MAIN DESCRIPTION

Type of vessel	PSV
Classification	DNV: +1A1, SF, EO, CLEAN, COMF-V(3), DK(+), HL (2,8), Dynpos AUTR
Place of build	SIMEK, Norway
Year of build	June 2007
Flag	NOR
Ship Owner	Rem Ship AS
Ship Manager	Rem Maritime AS
Design Company	Rolls Royce
Yard Number	115
IMO Number	9399155
Call Sign	LAKI

### MEASUREMENTS

Lenght o.a	73.60 m
Lenght b.p.p	67.69 m
Breath mld	16.00 m
Draft mld Main Deck	7.00 m
Draft Summer	5.84 m
Dead Weight tonnes	3326 t
Gross tonnage	2239 t
Net tonnage	1030 t
Displacement summer	4994 t

### MACHINERY

Main Engines	2 X 2005 kW, Total 4010 kW Type Caterpillar 3606 TA
Shaft Generators	2 x 1440 kW, Marelli – MJR 500 SC
Auxiliary Generators	2 x 260 kW, Type Nogva / Scania DI 12 62M
Emergency Generator	1 x 48 kW, Type Nogva / John Deere

### VESEL SPEED

Max speed	Approx 14.8 knots
Economic speed	Approx 10.5 knots

### CONSUMPTION

Max speed	Approx 22 m <sup>3</sup>
Economic speed	Approx 13 m <sup>3</sup>
DP Operation	Approx 8 - 10 m <sup>3</sup>
St. by at sea	Approx 7 m <sup>3</sup>
Port consumption	Approx 1 m <sup>3</sup>

### THRUSTER

Stern thrusters	2 Tunnel thrusters x 590 kW, Kamewa TT 1650 CP
Bow thrusters	2 Tunnel thrusters x 590 kW, Kamewa TT 1650 CP

### CAPACITIES

Deck load max	1600 t
Dry Bulk Capacities	319 m <sup>3</sup> in 5 tanks
Ballast Water	1530 m <sup>3</sup>
Potable/Fresh Water	820 m <sup>3</sup>
Drill Water	1280 m <sup>3</sup>
Liquid Mud	965 m <sup>3</sup> (included Brine tanks)
Brine	390 m <sup>3</sup>
Base Oil	200 m <sup>3</sup>
Fuel Oil	970 m <sup>3</sup>
Slop	965 m <sup>3</sup> (Mud and Brine tanks)

### DISCHARGE

Dry Bulk	2 x 0-30 m <sup>3</sup> / min at 5.6 bar
Fresh Water	150 m <sup>3</sup> / hr at 9 bar – 2 speed
Drill water	200 m <sup>3</sup> / hr at 9 bar – 2 speed
Liquid Mud (SG 2.5)	2 x 75 m <sup>3</sup> / hr at 24 bar – 2 speed
Brine (SG 2.0)	75 m <sup>3</sup> / hr at 24 bar
Base oil	150 m <sup>3</sup> / hr at 9 bar
Fuel Oil	200 m <sup>3</sup> / hr at 9 bar – 2 speed
Slop	2 x hydraulic pumps

Reducer fittings available

### DECK EQUIPMENT

Deck Dimensions	51 m x 13.5 m
Deck Area	680 m <sup>2</sup>
Deck Area workable	660 m <sup>2</sup>
Deck Strength	5 t/m <sup>2</sup>
Capstans	2 x 8 tonnes
Windlass	2 x 8 tonnes
Mooring winch	2 x 8 tonnes
Tugger winches	2 x 10 tonnes
Deck Crane	1 x 3 tonnes at 16 m
Tank Washing	Type Ing. Per Gjerdrum
Crash barrier height	2.8 m
Life Rafts	4 x DSB 25 persons.
Man Overboard Boat	1 x Viking GRP 470.
Power distribution panels	4 x 230 V 16 Amp. 3 phase + earth 2 x 440 V 32 Amp. 3 phase + earth 4 x 440 V 16 Amp. 3 phase + earth 2 x 440 V 16 Amp. 3 phase + earth 2 x 230 V 16 Amp. 3 phase + earth 1 x 440 V 32 Amp. 3 phase + earth

### DYNAMIC POSITION

Class	DP II
Type	Rolls Royce Icon DP II (AUTR)
Reference systems	2 x DGPS Veripos spotbeam 1 x CyScan

- F.W.
- W.B.
- F.O.
- BRINE/W.B.
- MUD
- BULK

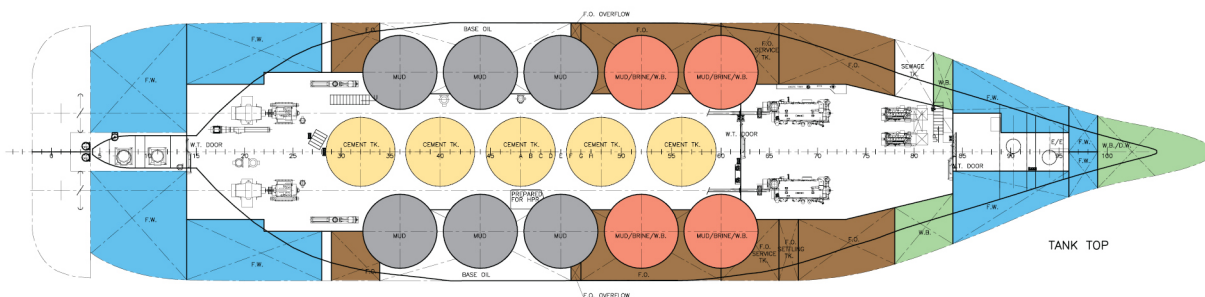
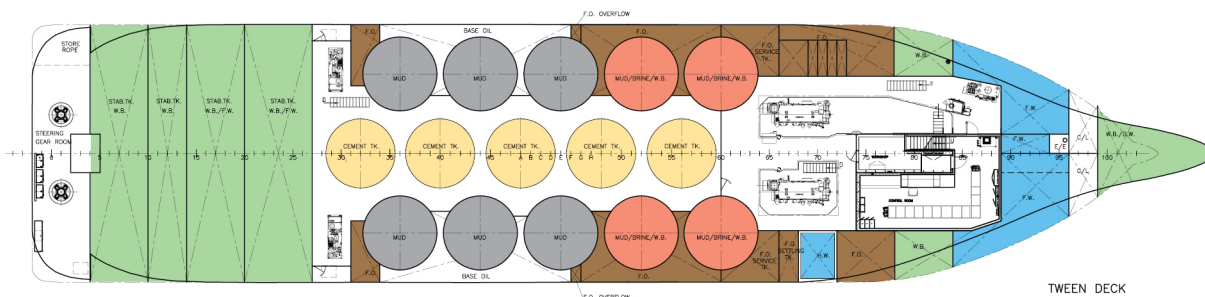
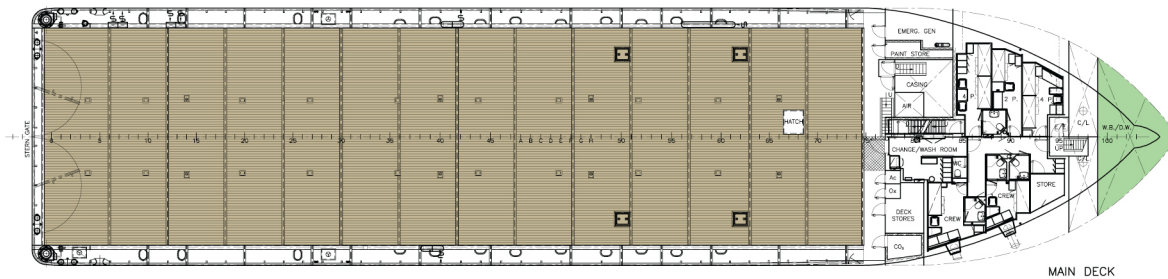
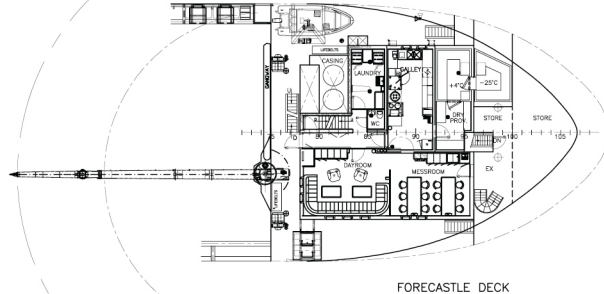
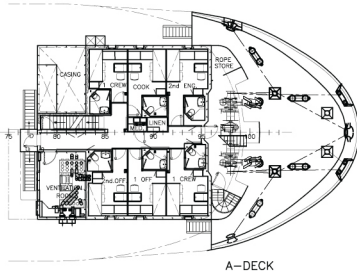
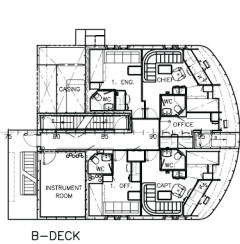
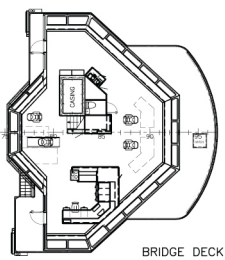
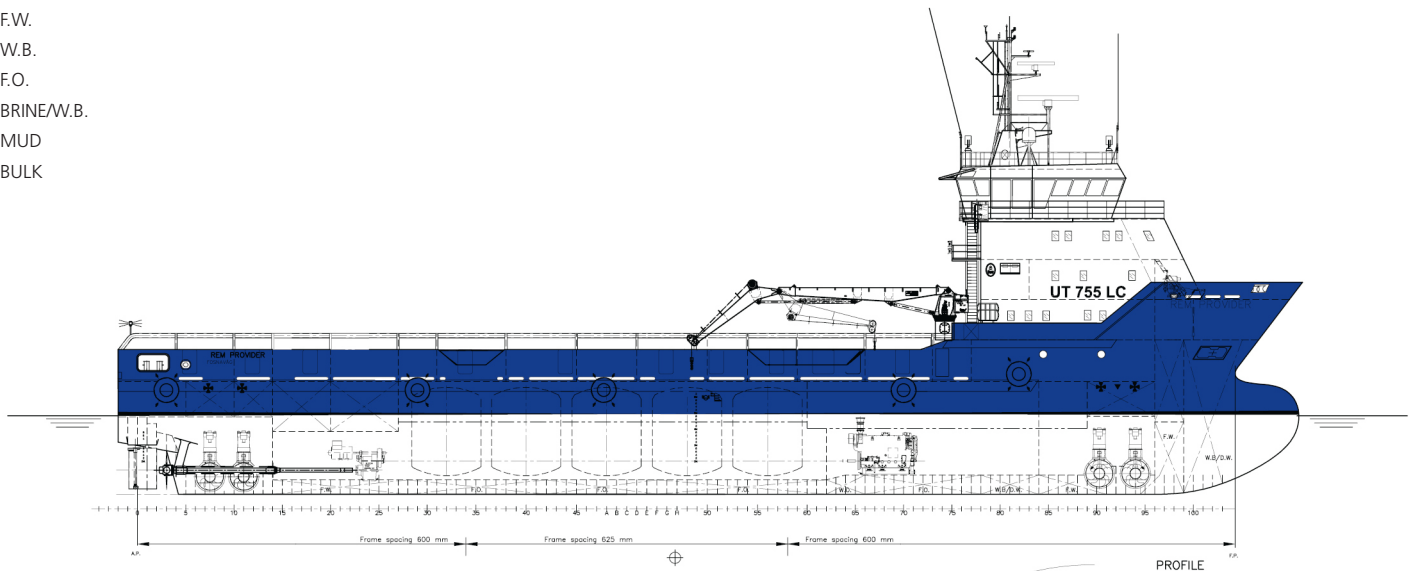

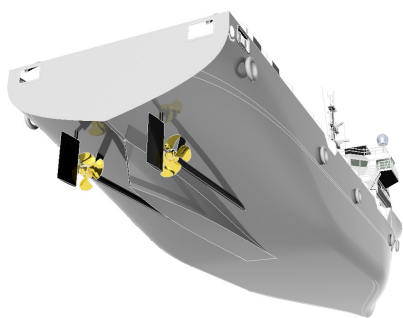
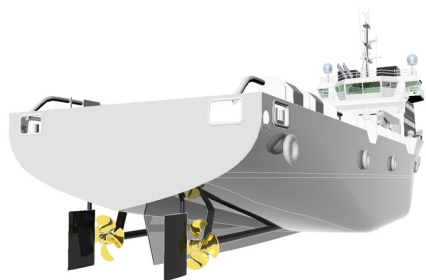
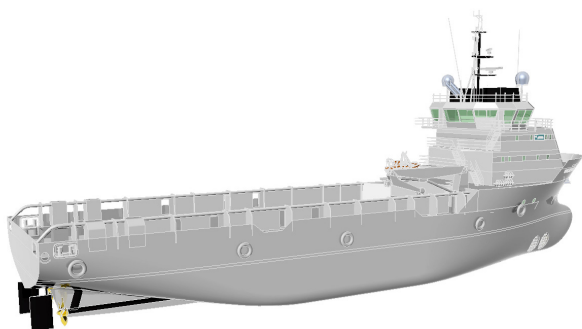

*The REM fleet is a modern and sophisticated fleet, designed by experienced and recognized Norwegian naval architects and built to a high quality by experienced yards in Norway.*

#### NAVIGATION EQUIPMENT

Radars	1 x 10 cm FAR 2137S
	1 x 3 cm FAR 2117
Autopilot	Anschutz Pilotstar D
Gyro	Anschutz ST 22
Navtex	Furuno NX 700 B
GPS /DGPS	2 x Furuno GP 150
Echo sounder	Furuno Echosounder FE 700
El-Chart / ECDIS	Telechart T 2121
AIS	Furuno FA 150
ELRIT	Sailor TT-3000 LRIT

#### COMMUNICATION EQUIPMENT

GMDSS	A3 type Furuno
Intercom	Vingtor Alpha- com E 20 Type ACM E 20
Satcom	1 x Iridium
	+881 621 412 829
VHF	2 x Furuno FM-8800S
	1 x Furuno FM-2721
Mobile phone	+47 90 81 22 43
TV System	Seatel
V-Sat system	Shipequip Sevsat 4006
	+47 21 61 59 62 / 63

#### CONTACT DETAILS

Phone	+47 21 61 59 62
	+47 21 61 59 63
	+47 90 81 22 43
	+881 621 412 829
Emails	bridge.provider@rem-maritime.no
	Captain.provider@rem-maritime.no

#### ACCOMMODATION

	Number of cabins
Single cabins	12 of
2 man cabins	1 of
4 man cabins	2 of
Medical locker	1 of
Total Accommodation	22 Berths.
	All cabins are fully Air-conditioned
Laundry	1 of
Messroom	1 of
Dayrooms	1 of
Galley	1 of
Cool store	1 of
Freezers	1 of
Dry provision	1 of
Offices	1 of
Gymnasium	1 of

#### ANCHORING EQUIPMENT

Anchor Points	2 x 12 tonnes
Winches	2 x electric hydraulic driven anchor / mooring

All data are believed to be correct but are not guaranteed.

3D illustration is of an almost identical sister ship.  
For exact details please see the GA plan.

The vessel specifications are subject to modifications and may change without prior notice.





*Rem Maritime AS was founded in 1996 with Åge Remøy as owner after a spin-off in a family company, where the activity was mainly fishing. The Company manages today both fishing and offshore service vessels.*



Manager: **Rem Maritime AS**  
Owner: **Rem Ship AS**  
P.O.Box 143, N-6099 Fosnavåg  
Tel.: +47 70 08 11 60,  
Fax: +47 70 08 11 65  
[www.rem-maritime.no](http://www.rem-maritime.no)

